

# etúHOME

Modular Cabinetry





# etúHOME

The European Inspired Kitchen

etúHOME is inspired by the quintessential European lifestyle, capturing the spirit that life is best enjoyed around food, wine, friends and family. All furniture we create is rooted in classic European designs and is updated for the modern home. Each piece is handcrafted by artisans using sustainably-sourced materials and is made-to-order.

## Why Choose etúHOME?



Reclaimed Wood

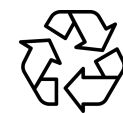

Recycled Glass



Artisan-Crafted



Time-Honored



Food-Safe





# European Design Made Simple

Our collection of modular cabinets are made simple for the modern home. Inspired by classically rooted European design, this collection features personalized modular cabinets that transform any space to be sophisticated and functional.

- ✓ Easy Personalization
- ✓ Indoor/Outdoor
- ✓ Plug and Play
- ✓ Fully Assembled
- ✓ Powder-Coated Steel
- ✓ Soft-Close Hinges
- ✓ Adjustable Feet
- ✓ Lasts a Lifetime



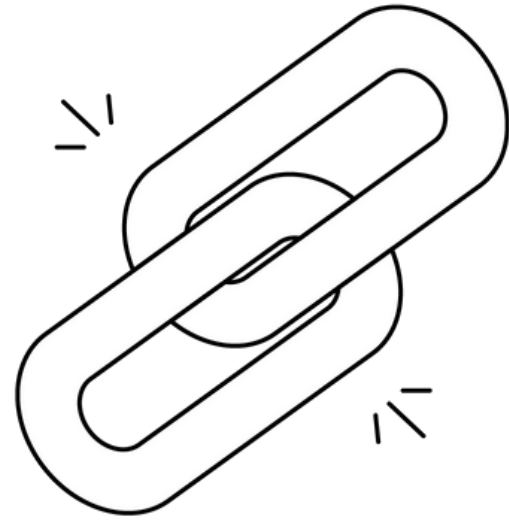

## Made to Last

---

Crafted with precision, each unit is free-standing, allowing them to move anywhere you go for a lifetime.

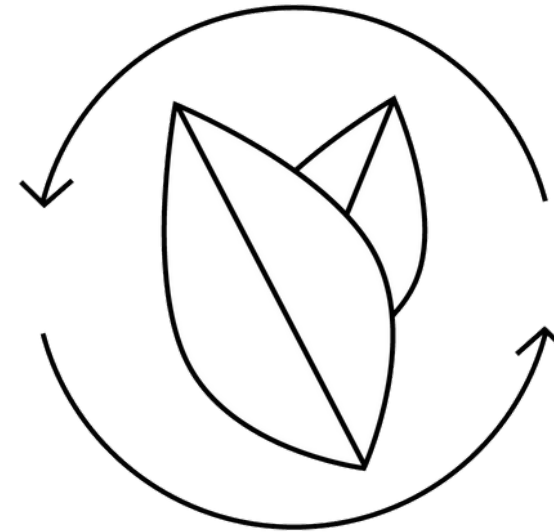

## Honest Materials

---

All drawer fronts and cabinet bodies are made of steel for enhanced durability. Drawers are fabricated from wood.

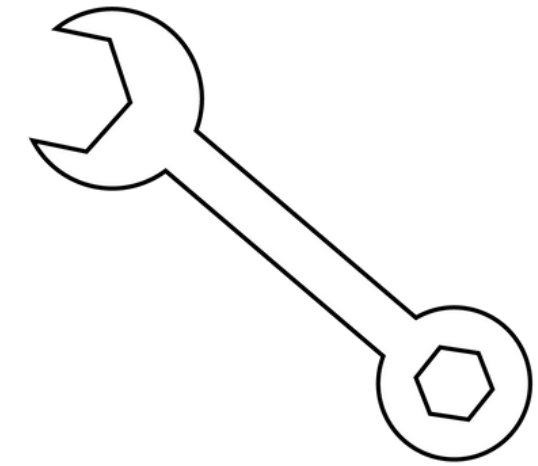

## Easy Assembly

---

All modular cabinets are fully assembled when delivered and are engineered for easy installation with a fabricator.



# How It Works

---



## 1. Choose Your Cabinets

Mix and match base, appliance, wall, storage and display cabinets for a personalized look.

## 2. Choose Your Color

Pick from our palette of trending colors: black, white or navy.

## 3. Choose Your Hardware

Pick your handle finish: gold, silver or black.

## 4. Finish with a Fabricator

Select countertops of choice with a fabricator for a seamless install.



# 1. Choose Your Cabinets

Mix and match base, appliance, wall hanging, storage and display cabinets for a personalized look.

- ✓ Sizes range from 24" to 48"
- ✓ Wall Hanging Cabinets available with standard glass, fluted glass or solid metal
- ✓ Appliance units: sink, fridge, microwave and dishwasher
- ✓ Trash Cabinet features built-in cutting board
- ✓ Indoor/outdoor steel cabinets perfect for a kitchen, office, laundry room, bathroom, office or patio.

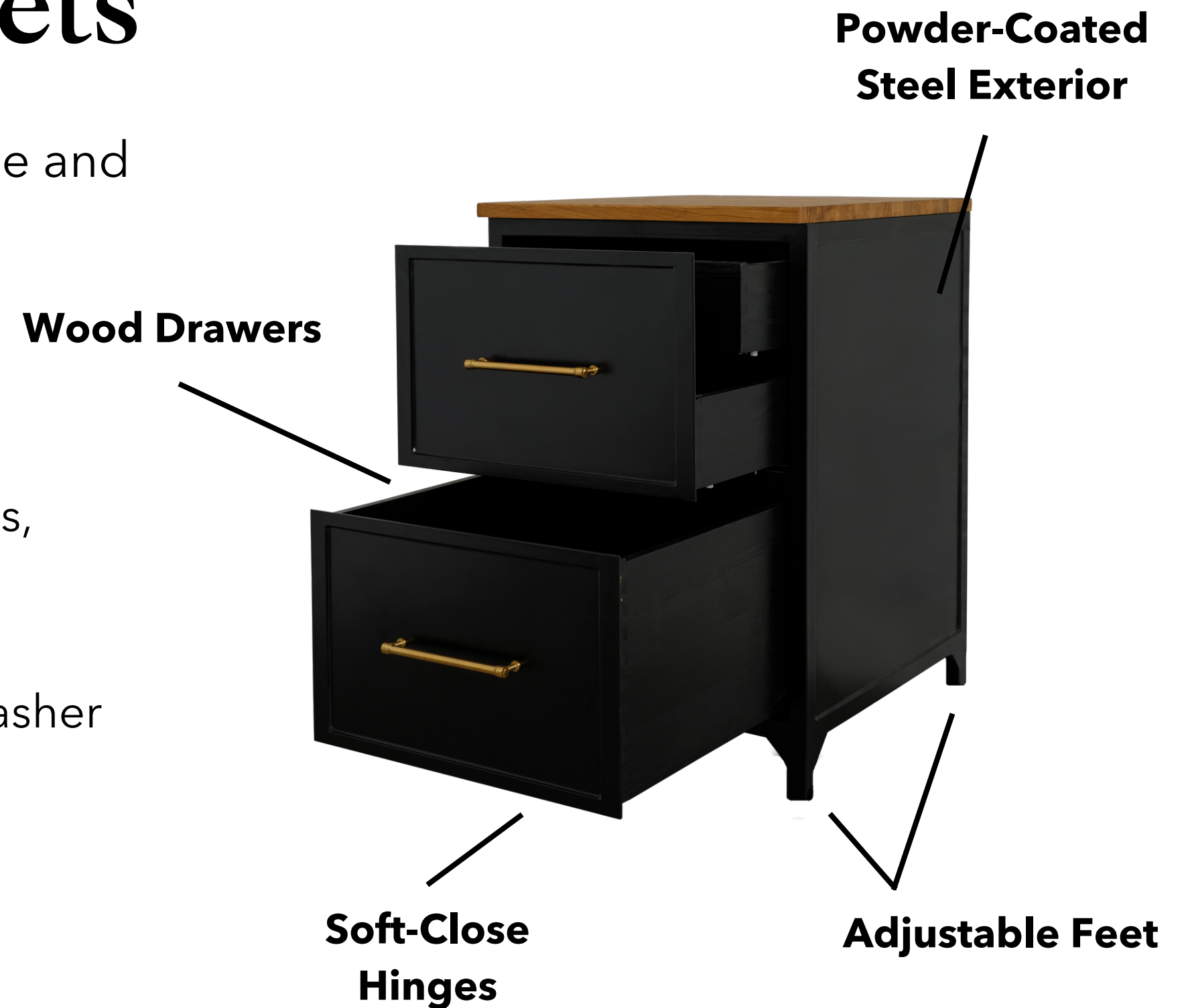



## 2. Choose Your Color



White  
(RAL 9003)

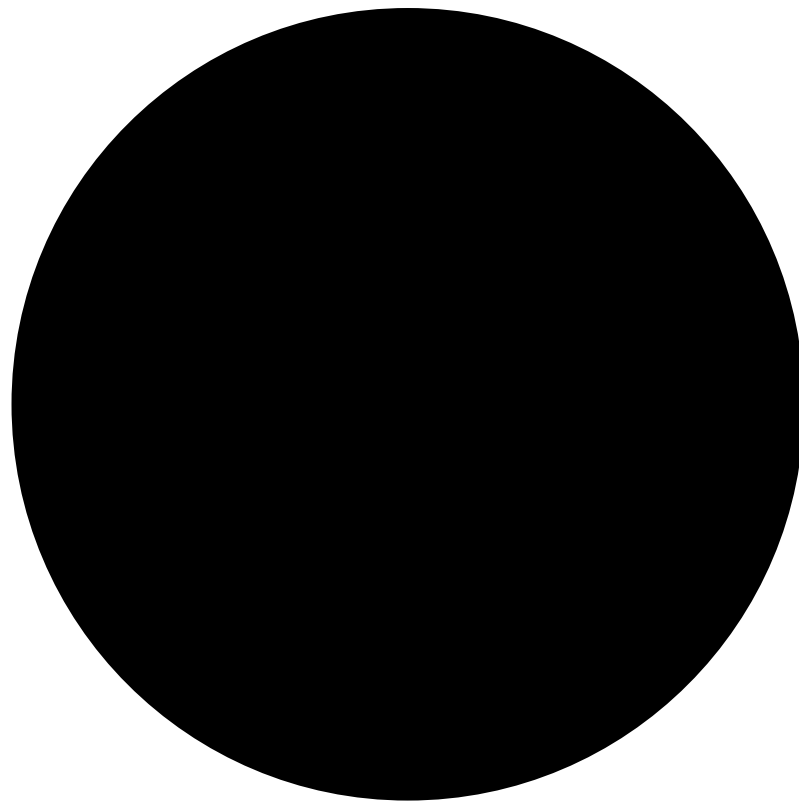

Black  
(RAL 9005)

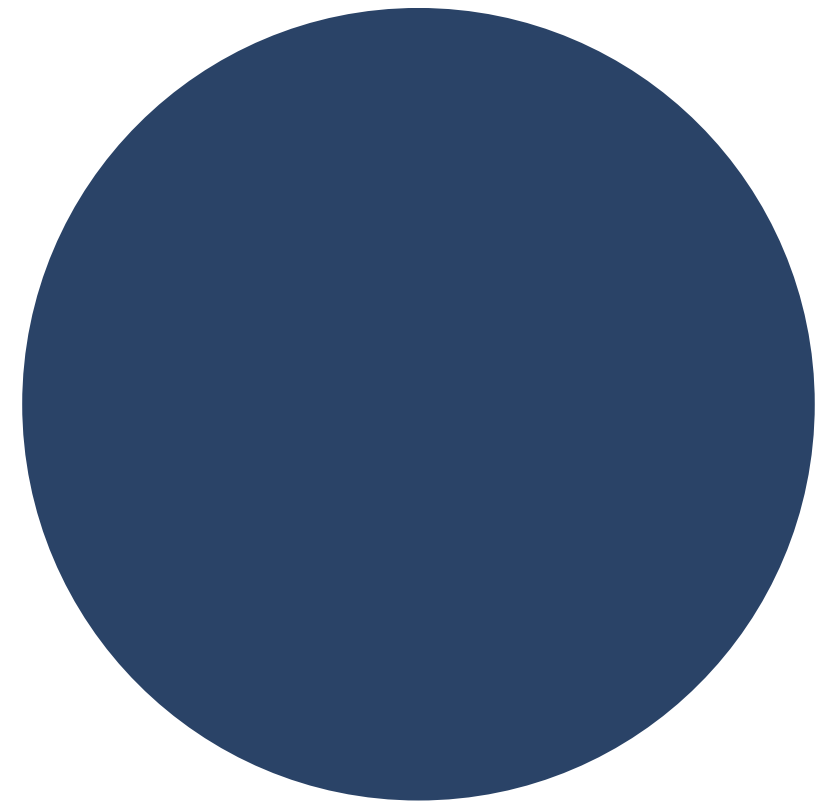

Navy  
(RAL 5008)

\*Color swatches available for purchase



### 3. Choose Your Hardware



Gold  
Pull



Silver  
Pull



Black  
Pull



# Pricing Comparison



Ikea

\$5k - \$15k

*etú*HOME

Modular Cabinets

\$10k - \$30k

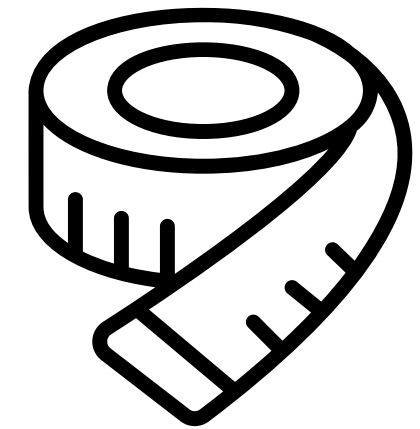

Custom

\$100k+

*\*Based on a 15' x 20' kitchen*

*etú*HOME



# Wall Hanging Cabinets



# Wall Hanging Cabinets - *Clear Glass Doors*

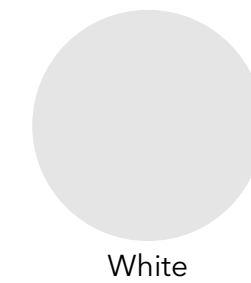

White

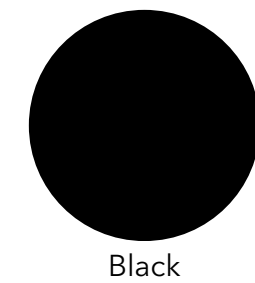

Black

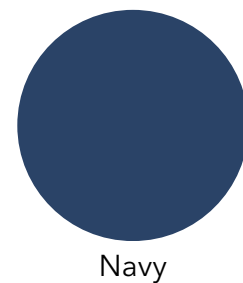

Navy



**Wall Hanging Glass  
Display Cabinet, 24"**

*Right or Left Side Hinge*  
Tall: L: 24" W: 16" H: 54"  
Short: L: 24" W: 16" H: 42"

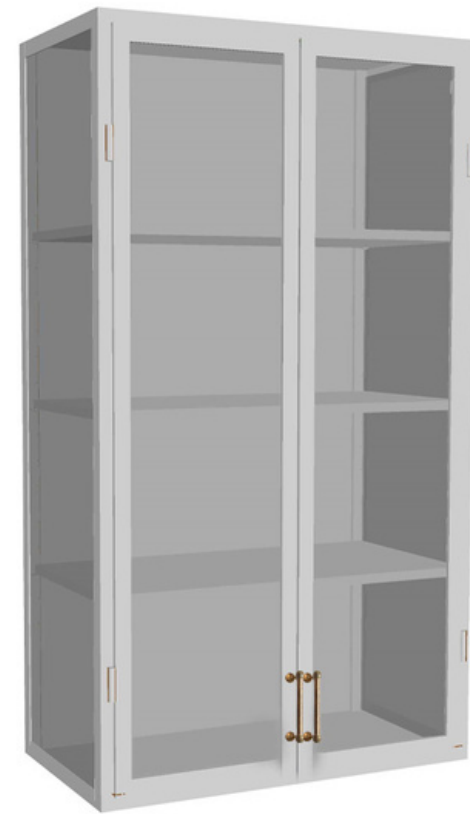

**Wall Hanging Glass  
Display Cabinet, 30"**

*Tall: L: 30" W: 16" H: 54"*  
*Short: L: 30" W: 16" H: 42"*



**Wall Hanging Glass  
Display Cabinet, 36"**

*Tall: L: 36" W: 16" H: 54"*  
*Short: L: 36" W: 16" H: 42"*



**Wall Hanging Glass  
Display Cabinet, 48"**

*Tall: L: 48" W: 16" H: 54"*  
*Short: L: 48" W: 16" H: 42"*



# Wall Hanging Cabinets - *Fluted Glass Doors*

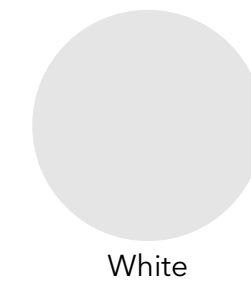

White

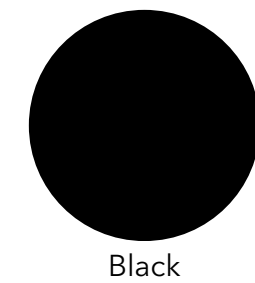

Black

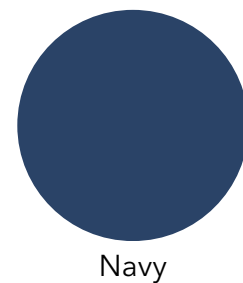

Navy

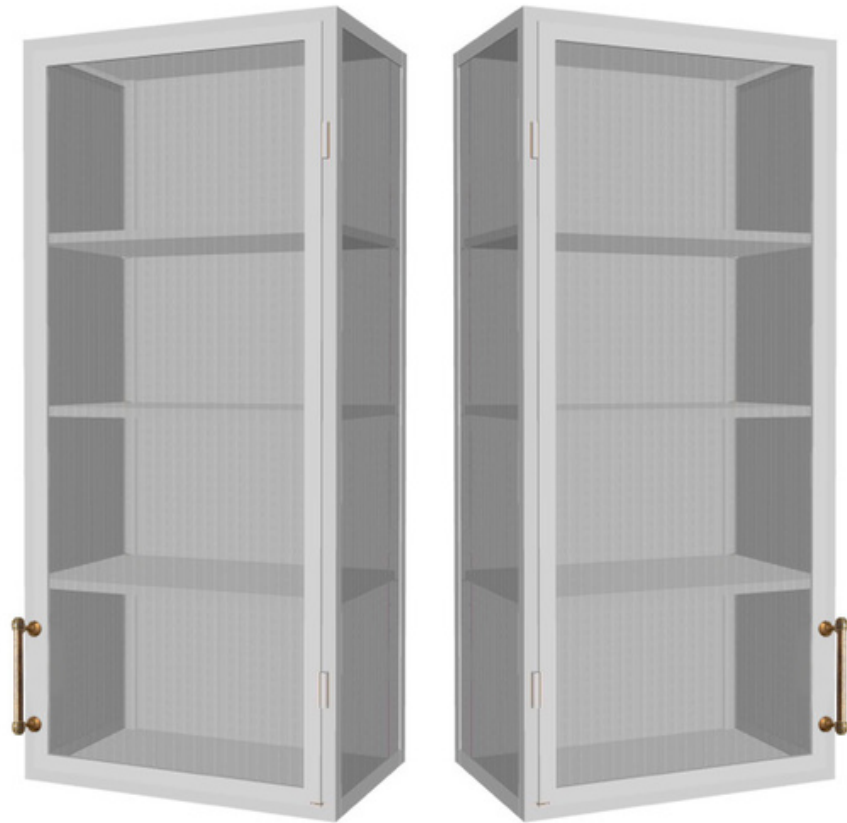

**Wall Hanging Fluted Glass  
Display Cabinet, 24"**

*Right or Left Side Hinge*  
Tall: L: 24" W: 16" H: 54"  
Short: L: 24" W: 16" H: 42"



**Wall Hanging Fluted Glass  
Display Cabinet, 30"**

*Tall: L: 30" W: 16" H: 54"*  
*Short: L: 30" W: 16" H: 42"*



**Wall Hanging Fluted Glass  
Display Cabinet, 36"**

*Tall: L: 36" W: 16" H: 54"*  
*Short: L: 36" W: 16" H: 42"*



**Wall Hanging Fluted Glass  
Display Cabinet, 48"**

*Tall: L: 48" W: 16" H: 54"*  
*Short: L: 48" W: 16" H: 42"*



# Wall Hanging Cabinets - *Metal Doors*

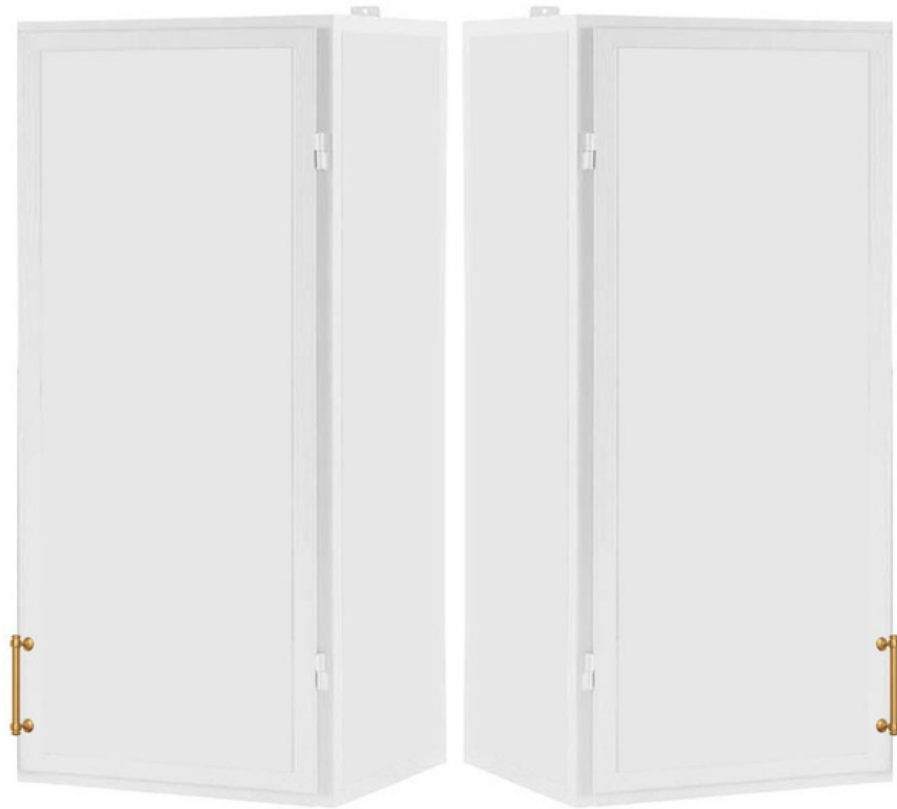
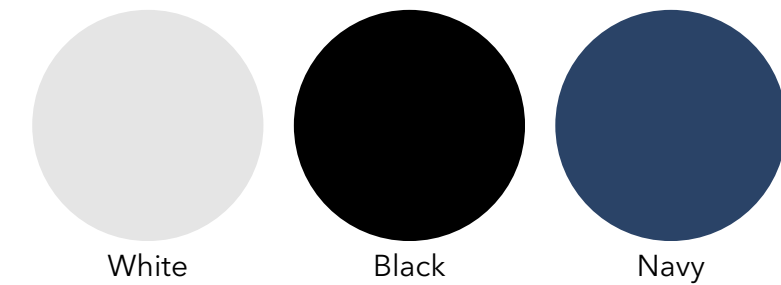

**Wall Hanging Metal  
Display Cabinet, 24"**

---

*Right or Left Side Hinge*  
Tall: L: 24" W: 16" H: 54"  
Short: L: 24" W: 16" H: 42"

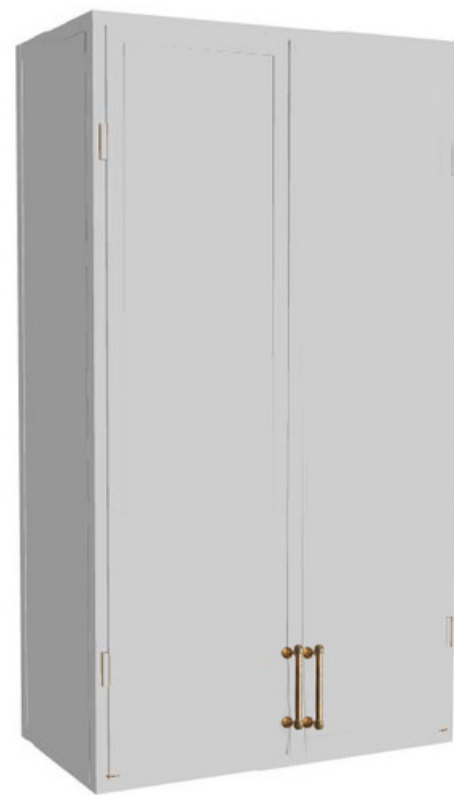

**Wall Hanging Metal  
Display Cabinet, 30"**

---

*Tall: L: 30" W: 16" H: 54"*  
*Short: L: 30" W: 16" H: 42"*



**Wall Hanging Metal  
Display Cabinet, 36"**

---

*Tall: L: 36" W: 16" H: 54"*  
*Short: L: 36" W: 16" H: 42"*



**Wall Hanging Metal  
Display Cabinet, 48"**

---

*Tall: L: 48" W: 16" H: 54"*  
*Short: L: 48" W: 16" H: 42"*





# Base Cabinets



# Base Cabinets

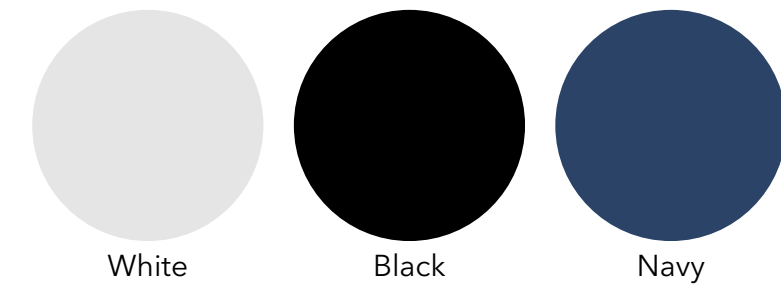

**2-Drawer Base Cabinet, 24"**

---

*L: 24" W: 24.6" H: 35"*



**2-Drawer Base Cabinet, 30"**

---

*L: 30" W: 24.6" H: 35"*



**2-Drawer Base Cabinet, 36"**

---

*L: 36" W: 24.6" H: 35"*

*\*Cabinets feature a hidden top drawer*

# Base Cabinets

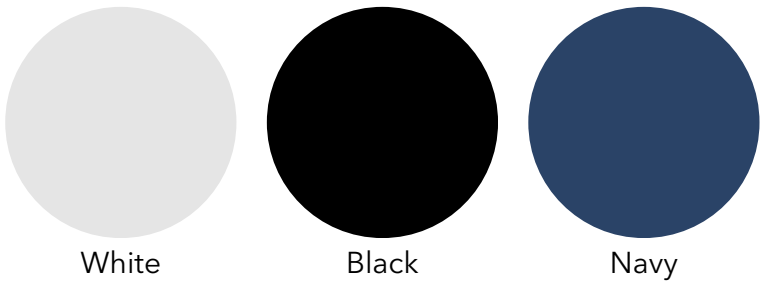

**3-Drawer Base Cabinet, 24"**

*L: 24" W: 24.6" H: 35"*



**3-Drawer Base Cabinet, 30"**

*L: 30" W: 24.6" H: 35"*



**3-Drawer Base Cabinet, 36"**

*L: 36" W: 24.6" H: 35"*



# Base Cabinets

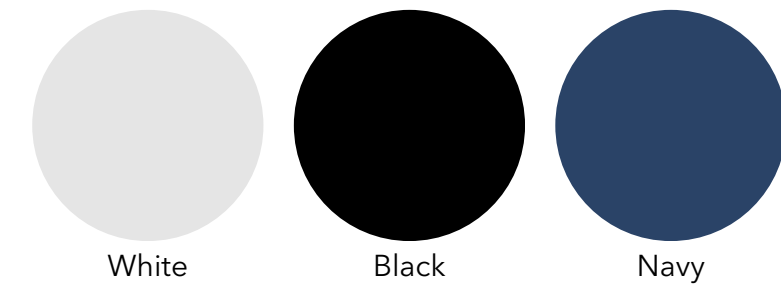

**6-Drawer Base Cabinet, White, 48"**

---

*L: 48" W: 24.6" H: 35"*



**Trash Base Cabinet, 24"**

---

*L: 24" W: 24.6" H: 35"*

*\*Trash Cabinet features a built-in cutting board*

# Base Cabinets

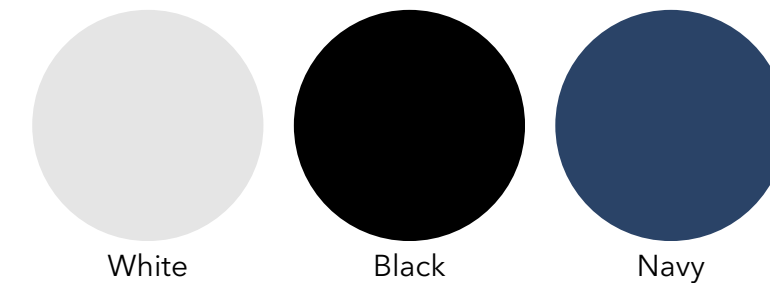

**Sink 2-Drawer Base Cabinet, 24"**

---

*L: 24" W: 24.6" H: 35"*



**Sink 2-Drawer Base Cabinet, 36"**

---

*L: 36" W: 24.6" H: 35"*



**Dishwasher Shell Base Cabinet**

---

*L: 26.8" W: 24.5" H: 35"*  
*Inside Opening: L: 24.4" H: 33.9"*



# Base Cabinets

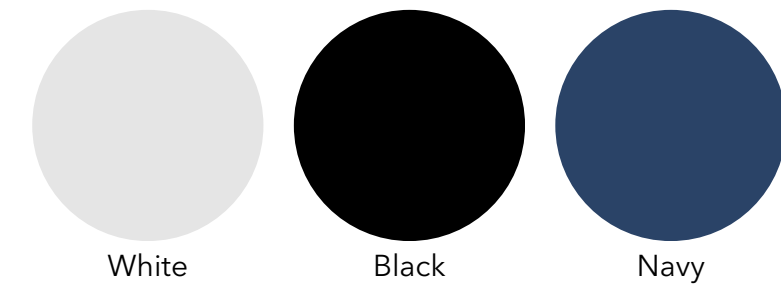

**Spice Drawer Base Cabinet**

---

*L: 12" W: 24.6" H: 35"*



**Wine Storage Base Cabinet**

---

*L: 16.5" W: 24.6" H: 35"*



**Vertical Storage Base Cabinet**

---

*L: 12" W: 24.6" H: 35"*



# Base Cabinets

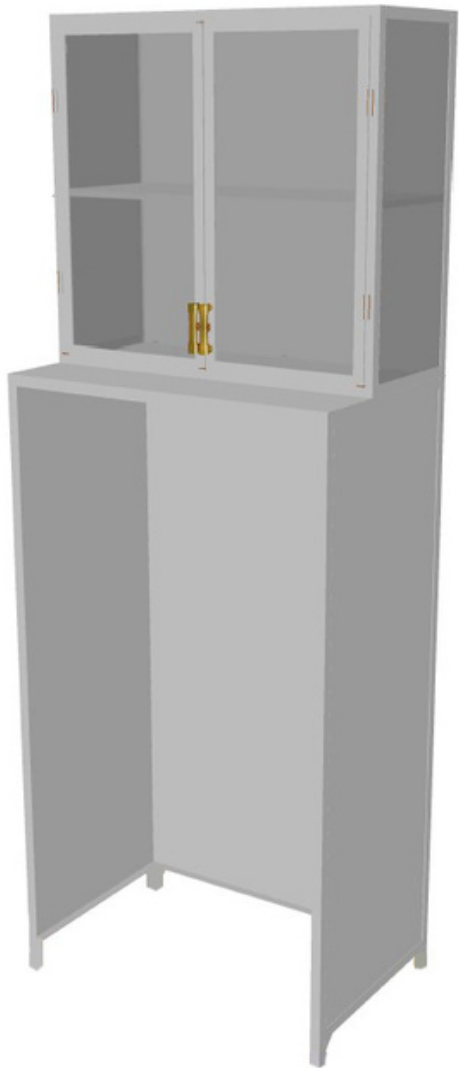
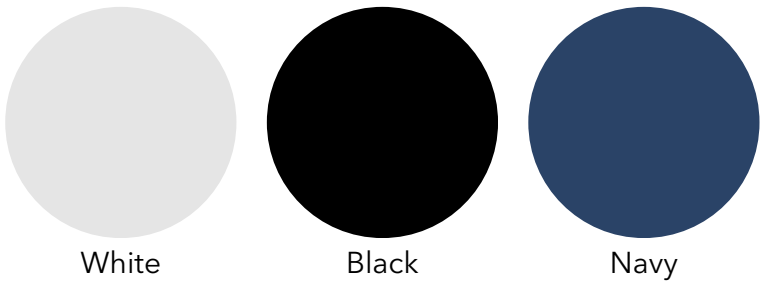

**Fridge Cabinet**

*L: 39.4" W: 24.6" H: 107.9"*



**Microwave Drawer Base Cabinet**

*L: 33.1" W: 24.6" H: 35"*

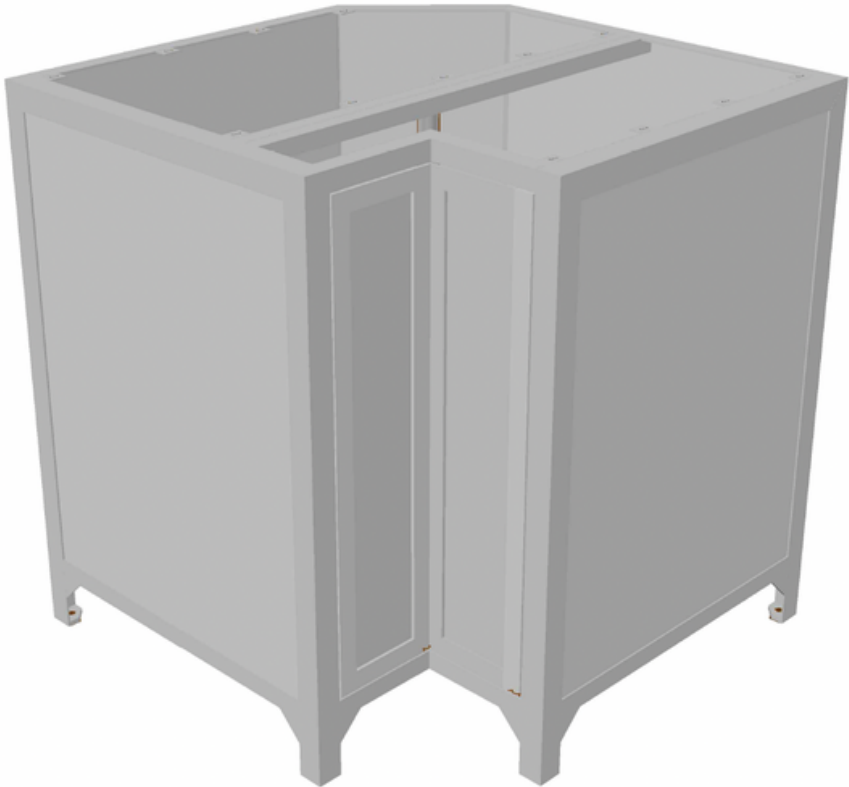

**Corner Base Cabinet**

*L: 33.1" W: 33.1" H: 35"*





# Storage Cabinets



# Display/Storage Cabinets



White

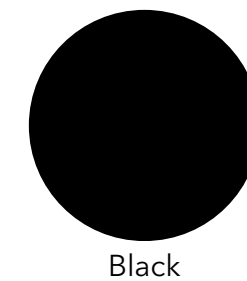

Black

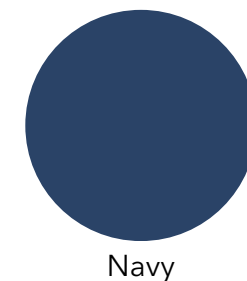

Navy



**Laundry Storage Cabinet**

*L: 35.4" W: 15.7" H: 86.6"*



**2-Door Glass Display Cabinet**

*L: 35" W: 15.7" H: 87.4"*

# Display/Storage Cabinets

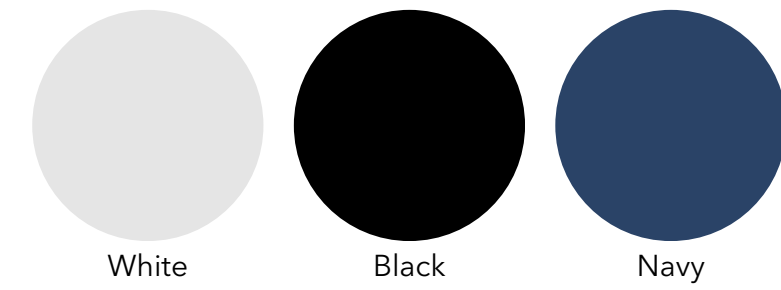

**6-Drawer Storage Cabinet**

*L: 48" W: 16" H: 76"*



**2-Door Storage Cabinet**

*L: 36" W: 26" H: 87.8"*



**4-Door Storage Cabinet**

*L: 36" W: 26" H: 96"*



# Display/Storage Cabinets

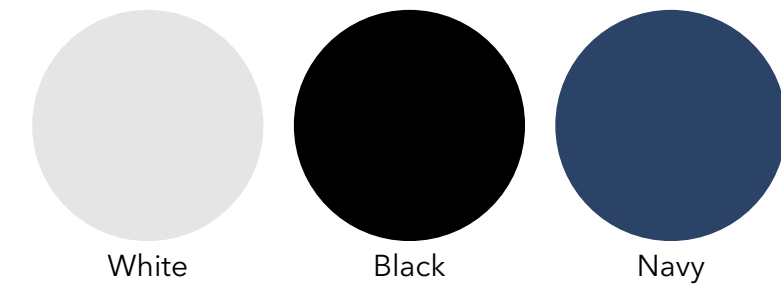

**2-Door Glass Storage Cabinet**

*L: 35" W: 16" H: 87"*



**2-Door Glass Storage Cabinet with Counter**

*L: 39.7" W: 26" H: 87"*

# Display/Storage Cabinets

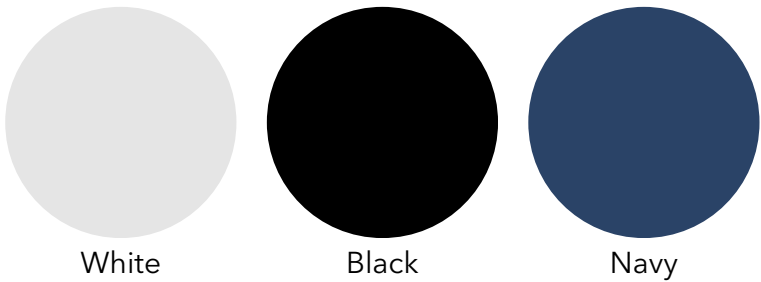

**3-Door Glass Storage Cabinet**

*L: 59" W: 18" H: 87"*



**3-Door Glass Storage Cabinet with Counter**

*L: 60" W: 26" H: 87"*







# FAQ's

- Design consultations and space planning available via our Corporate Designer
- Cabinetry pricing and freight quotes available upon request
- Fabricated from powder-coated steel
- Made to order, estimated lead time ranges from 12-14 weeks
- 50% deposit required to confirm order



# etúHOME

Contact Our Corporate Designer:

✉ [Laura.Giertz@etuhome.com](mailto:Laura.Giertz@etuhome.com)

☎ 612-240-9627

🌐 [etuhome.com](http://etuhome.com)

